

Acessório Injetado PEAD

Fabricado em PE100-RC preto;

Adequado para redes de água (EN 12201 – ISSO 4427).



**SDR26
PN6**

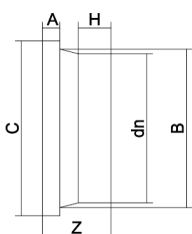

dn	código	H [mm]	Z [mm]	B [mm]	C [mm]	A [mm]	Peso [Kg]
160	CCP160A	25	70	175	206	14	0,43
180	CCP180A	30	86	180	206	16	0,44
200	CCP200A	41	108	232	261	19	1,12
225	CCP225A	32	99	235	261	19	0,87
250	CCP250A	38	109	285	316	20	1,66
280	CCP280A	63	114	291	316	20	1,38
315	CCP315A	64	119	335	372	20	2,06
355	CCP355A	50	115	373	422	24	2,73
400	CCP400A	46	118	427	472	26	3,68
450	CCP450A	63	140	514	577	36	7,60
500	CCP500A	62	127	530	577	36	6,09
560	CCP560A	54	132	615	678	40	10,60
630	CCP630A	44	120	642	678	40	7,60
710	CCP710A	40	125	737	782	42	11,60
800	CCP800A	30	120	840	888	43	14,80
900	CCP900A	40	130	944	988	47	19,40
1000	CCP1000A	40	130	1047	1088	52	22,93
1200	CCP1200A	35	153	1245	1305	63	39,10

Acessório Injetado PEAD

Fabricado em PE100-RC preto;

Adequado para redes de água (EN 12201 – ISSO 4427).



**SDRI17
PN10**

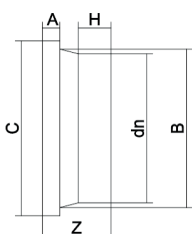

dn	código	H [mm]	Z [mm]	B [mm]	C [mm]	A [mm]	Peso [Kg]
63	CCP063B	27	64	75	103	14	0,13
75	CCP075B	27	67	89	123	16	0,22
90	CCP090B	26	69	105	139	17	0,26
*110	CCP110B	25	73	125	159	18	0,36
*125	CCP125B	30	76	132	159	18	0,41
*140	CCP140B	30	80	155	189	18	0,53
*160	CCP160B	25	75	175	213	18	0,65
*180	CCP180B	76	102	180	213	20	0,81
*200	CCP200B	41	115	232	269	24	1,60
*225	CCP225B	35	99	235	269	24	1,40
*250	CCP250B	45	109	285	321	25	2,27
*280	CCP280B	66	111	291	321	25	2,19
*315	CCP315B	65	132	335	371	25	3,37
*355	CCP355B	51	124	373	431	30	4,33
*400	CCP400B	52	121	427	483	33	5,60
450	CCP450B	67	143	514	586	45	10,90
*500	CCP500B	60	129	530	594	45	9,20
*560	CCP560B	54	135	615	686	50	14,00
*630	CCP630B	46	131	642	694	50	12,80
710	CCP710B	35	128	737	801	52	17,80
800	CCP800B	40	125	840	906	53	22,40
900	CCP900B	40	130	944	1006	59	29,40
1000	CCP1000B	40	135	1047	1111	65	37,80
1200	CCP1200B	35	170	1245	1331	79	68,80

* Adequado para conexão com flange ASME B 16.5

Acessório Injetado PEAD

Fabricado em PE100-RC preto;

Adequado para redes de água (EN 12201 – ISSO 4427).



**SDR11
PN16**

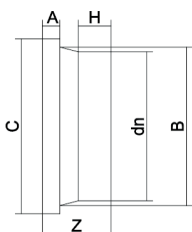

dn	código	H [mm]	Z [mm]	B [mm]	C [mm]	A [mm]	Peso [Kg]
63	CCP063C	23	60	75	103	14	0,16
75	CCP075C	25	65	89	123	16	0,23
90	CCP090C	26	70	105	139	17	0,31
110*	CCP110C	32	75	125	159	18	0,44
125*	CCP125C	26	74	132	159	24	0,50
140*	CCP140C	30	86	155	189	25	0,77
160*	CCP160C	25	84	175	213	25	0,97
180*	CCP180C	65	97	180	213	30	1,15
200*	CCP200C	50	129	232	269	32	2,34
225*	CCP225C	28	104	235	269	32	1,97
250*	CCP250C	39	116	285	321	35	3,33
280*	CCP280C	62	128	291	321	35	3,48
315*	CCP315C	66	143	335	371	35	5,09
355*	CCP355C	51	135	373	431	40	6,47
400*	CCP400C	53	137	427	483	45	8,60
450	CCP450C	65	157	514	586	60	15,60
500*	CCP500C	30	130	530	608	60	13,60
560*	CCP560C	56	156	615	686	60	21,20
630*	CCP630C	30	150	642	694	70	20,40
710	CCP710C	35	150	737	801	75	28,40
800	CCP800C	30	150	840	906	80	37,20
900	CCP900C	28	158	944	1006	90	49,20
1000	CCP1000C	40	170	1047	1110	100	62,20
1200	CCP1200C	40	205	1245	1331	120	106,00

* Adequado para conexão com flange ASME B 16.5

Acessório Injetado PEAD

Fabricado em PE100-RC preto;

Adequado para redes de água (EN 12201 – ISSO 4427).



SDR9 PN20

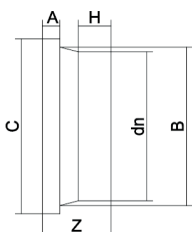

dn	código	H [mm]	Z [mm]	B [mm]	C [mm]	A [mm]	Peso [Kg]
*280	CCP280G	66	134	291	332	38	4,20
*315	CCP315G	76	158	335	392	40	6,45
355	CCP355G	52	140	373	449	47	8,30
*400	CCP400G	53	139	427	506	53	10,35
450	CCP450G	68	158	514	616	63	17,60
500	CCP500G	-	-	-	-	-	-
560	CCP560G	-	-	-	-	-	-
630	CCP630G	-	-	-	-	-	-

* Adequado para conexão com flange ASME B 16.5

SDR7,4 PN25

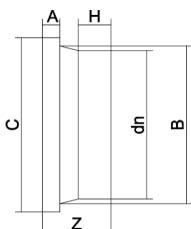

dn	código	H [mm]	Z [mm]	B [mm]	C [mm]	A [mm]	Peso [Kg]
*280	CCP280H	66	138	291	332	42	5,00
*315	CCP315H	76	165	335	392	47	7,70
355	CCP355H	52	148	373	449	53	9,80
*400	CCP400H	51	151	427	506	60	11,85
450	CCP450H	67	160	514	616	67	19,50
500	CCP500H	-	-	-	-	-	-
560	CCP560H	-	-	-	-	-	-
630	CCP630H	-	-	-	-	-	-

* Adequado para conexão com flange ASME B 16.5